

ANOLIS



P R O D U C T G U I D E 2 0 0 9 / 2 0 1 0

ANOLIS was established to design and manufacture top-end LED lighting products.

Since its conception, ANOLIS has gone from strength to strength, producing a constantly expanding range of products with a well balanced mix of innovation, imagination and experience. This, together with state-of-the-art lighting technology, has created a market leading range.

Reliability is the first priority. ANOLIS uses only the highest quality components and precision manufacturing techniques, ensuring that the brand offers all the benefits associated with LED lighting: extreme efficiency, long life, low maintenance, low heat and no UV output.

Combining these characteristics with industry standard dimensions and flexible control options, true specifier-class lighting systems can be created.

ANOLIS products can be seen in a wide variety of applications worldwide, and embrace many market sectors including architectural, commercial, industrial, transport, retail, domestic and entertainment lighting.

From discreet white colour-controlled accent lighting to full RGB building illumination, ANOLIS products present lighting designers and architects with creative solutions for the most demanding client requirements.

All ANOLIS products meet the relevant product directives and bear the CE mark. Some also bear the ETL Mark, and approval for the remaining products is currently pending.

Maintaining a close working relationship with the leading component manufacturers ensures that ANOLIS stays at the forefront of the ever-evolving LED market. New technologies are constantly allowing higher output and greater efficiency which continues to open up new market opportunities.

ANOLIS is the professional choice - both now and for the future.

ANOLIS ADVANTAGES

As the global LED lighting market is currently growing at a phenomenal rate there is a huge choice for today's lighting designers, specifiers and installers. When considering LED lighting it is important to choose a manufacturer who can provide the quality of both the product and level of service to ensure the required results are achieved. Anolis is able to offer the both the highest quality of product, supported by a global distribution network to ensure service levels to match.

- Anolis manufactures all of its LED products from the highest quality components available; working closely with the worlds leading component suppliers ensures the reliability and consistency demanded by today's wide range of lighting projects.
- Anolis LED products are designed, tested and manufactured at our state of the art European manufacturing facility in the Czech Republic, complete control over all stages of the manufacturing process combined with a vigorous testing regime ensures the highest level of quality control, giving designers and specifiers the confidence to choose Anolis.
- Keeping all stages of the manufacturing process in house allows Anolis to respond rapidly to custom products, the in house Design and R&D team are able to work closely with clients to produce custom designed products for the most demanding of projects.
- Anolis is able to offer a complete LED solution manufacturing both LED luminaries as well as the LED drivers and controllers' ensuring a matched system is available for the widest range of applications.
- Anolis custom software is utilized in all Anolis drivers to constantly monitor LED performance, drive currents continually adjusted to ensure optimum performance of LED's ensuring the maximum benefits of LED technology are achieved at all times.
- All relevant technology patents, meaning they can be specified and supplied with the utmost confidence, cover Anolis products.
- Anolis products meet or exceeds internationally recognized standards including CE, *ETL/UL, and SELV giving peace of mind to designers, specifiers and installers.

* (Anolis is continually developing its product range therefore please check individual products for conformity)

ANOLIS LED GREEN STATEMENT

Governments and Lighting professionals worldwide all agree that the recent advances in LED technology hold tremendous potential to conserve energy on a global scale.

Until now LED light sources have been restricted to specialty applications, due to there poor overall light output however LED's have progressed greatly and are now able to compete with conventional lighting technology in virtually all applications.

Today's advanced LED lamp sources are often in excess of 5X more efficient than incandescent and halogen lamp sources, and are on par with the efficiency of most fluorescent technologies, and the LED based technology continues to be the fastest developing technology within the lighting industry.

It is not only low power consumption that makes LED lighting environmentally acceptable in general they have much longer lifetimes than conventional sources, which translates to less maintenance and replacement costs and also less waste as they are also inherently free of mercury and other harmful elements. In short, low voltage energy efficient LED lighting systems help lighting professionals make ecologically-sound design choices today, while promising to have even greater positive impact on the future of the environment.

It is estimated that currently up to 20% of global electricity production is consumed by lighting! LED lighting technology offers now the ability for today's lighting specifiers designers and Architects to make a real difference for tomorrow.

With Government directives having already been introduced around the world effectively beginning the phasing out of inefficient incandescent and halogen light sources NOW is the time to choose LED lighting solutions.



ArcSource 1

The Anolis ArcSource 1 is a single colour high powered LED fixture utilising the latest Luxeon high output LED's. Available in 4 optical formats, beam, asymmetric beam x 2 or marker the ArcSource 1 has integrated electronic control allowing the fixture to operate on a range of AC/DC input voltages; the onboard electronic control also ensures that constant output intensity is maintained through all fixtures no matter where they are located in relation to the power supply.

Finished in 316 stainless steel with an IP rating of 68 and drive over load bearings, the ArcSource 1 offers completely flexible solutions to both interior and exterior environments.



ArcSource

TECHNICAL SPECIFICATIONS:

ArcSource 1™

Input Voltage:	9-35V DC or 6-24 V AC
Maximum Power Consumption:	1.6 Watts
Operating Ambient Temp. Range:	-20°C/+40°C
Cooling System:	convection
Optical Systems Available:	10°, super wide-angle beam, asymmetric beam
LED Device:	1 Watt Luxeon
Warm White LED (WW):	3300 K
Cool White LED (CW):	6500 K
Typical Lumen Maintenance:	70% @ 50.000 hours
Led Life Expectancy:	minimum 50.000 hours
Construction:	stainless steel top flange, brass housing
Glass covers:	flat tempered glass (clear), domed tempered glass (frosted)
Weight:	0.3 kg
Ingress Protection:	IP 68
IK rating:	IK 08
Power cable:	Ölflex Robust 210; 2x0.5 mm ² ; 1 meter long

LED Colour Variants:

R, G, B, A, CW, WW, NW

DIMENSIONS:

ArcSource 1

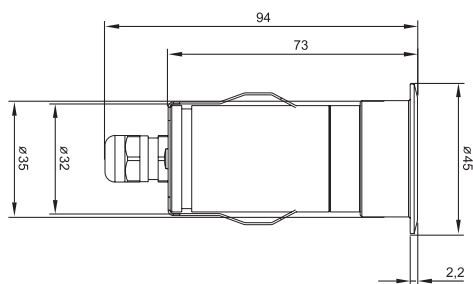

ArcSource 1 Super wide-angle

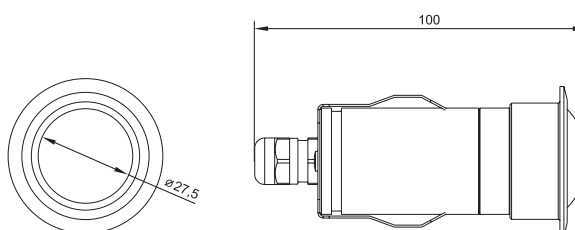



ArcSource 3, 6, 7 (MR16)

The Anolis ArcSource 3 RGB, 6 RGB, 7 RGBW combines state of the art lighting technology with industry standard MR16 fittings to create truly specifier class lighting systems. Using only the finest materials and precision manufacturing techniques the Anolis ArcSource 3 RGB, 6 RGB, 7 RGBW provides the professional solution for your lighting requirements.

The highest quality interchangeable optical system ensures that the desired effect can be achieved in the widest range of application possibilities. Utilising high powered Luxeon Emitters the Anolis ArcSource 3 RGB, 6 RGB, 7 RGBW is unsurpassed in performance, reliability and quality.



ArcSource

TECHNICAL SPECIFICATIONS:

	ArcSource 3™
Max input current:	350 mA
Maximum Power Consumption:	4.2 Watts
Compatible Power Supplies:	ArcPower 36, 72, 144, 360 ArcPower 16x6
Compatible Power Supplies for single colour variants:	ArcPower SmartWhite 36, 72, 144
Operating Ambient Temp.Range:	-20°C/+40°C
Operating Temperature:	+50°C @ ambient 25°C
Cooling System:	convection
Optical Systems Available:	6°, 15°, 25°, 38°
LED Device:	1Watt Luxeon
Warm White LEDs (WW):	3300 K
Cool White LEDs (CW):	6500 K
Typical Lumen Maintenance:	70% @ 50.000 hours
Led Life Expectancy:	minimum 50.000 hours
Construction:	precision turned aluminium
Weight:	0.15 kg
Installation method:	standard MR16 housings standard
Ingress Protection:	IP 2X
Flammability:	94V-0 flame class rating
Power/Data plug:	RJ45
Power/Data cable:	24 AWG x 4P; cat. 5e; 1.5m long
Accessories:	Diffuser, MR16-Down Light Fitting

LED Colour Variants: RGB, R, G, B, A, CW, WW, NW

	ArcSource 6™
Max input current:	350 mA
Maximum Power Consumption:	8.4 Watts
Compatible Power Supplies:	ArcPower 36, 72, 144, 360 ArcPower 16x6
Compatible Power Supplies for single colour variants:	ArcPower SmartWhite 36, 72, 144
Operating Ambient Temp.Range:	-20°C/+40°C
Operating Temperature:	+56°C @ ambient 25°C
Cooling System:	convection
Optical Systems Available:	6°, 25°
LED Device:	1 Watt Luxeon
Warm White LEDs (WW):	3300 K
Cool White LEDs (CW):	6500 K
Typical Lumen Maintenance:	70% @ 50.000 hours
Led Life Expectancy:	minimum 50.000 hours
Construction:	precision turned aluminium
Weight:	0.25 kg
Installation method:	MR16 housings standard
Ingress Protection:	IP 2X
Flammability:	94 V-2 flame class rating
Power/Data plug:	RJ45
Power/Data cable:	24 AWG x 4P; cat. 5e; 1.5m long
Accessories:	Diffuser, MR16-Down Light Fitting

LED Colour Variants: RGB, RGBWW, RGBCW, R, G, B, A, CW, WW, NW

	ArcSource 7™
Max input current:	350 mA
Maximum Power Consumption:	9.6 Watts
Compatible Power Supplies:	ArcPower 36, 72, 144, 360 ArcPower 16x6
Compatible Power Supplies for single colour variants:	ArcPower SmartWhite 36, 72, 144
Operating Ambient Temp.Range:	-20°C/+40°C
Operating Temperature:	+60°C @ ambient 25°C
Cooling System:	convection
Optical Systems Available:	6°, 25°
LED Device:	1 Watt Luxeon
Warm White LEDs (WW):	3300 K
Cool White LEDs (CW):	6500 K
Typical Lumen Maintenance:	70% @ 50.000 hours
Led Life Expectancy:	minimum 50.000 hours
Construction:	precision turned aluminium
Weight:	0.25 kg
Installation method:	MR16 housings
Ingress Protection:	IP 2X
Flammability:	94V-2 flame class rating
Power/Data plug:	RJ45
Power/Data cable:	24 AWG x 4P; cat. 5e; 1.5m long
Accessories:	Diffuser, MR16-Down Light Fitting

LED Colour Variants: RGBCW, RGBWW, R, G, B, A, CW, WW, NW

DIMENSIONS:

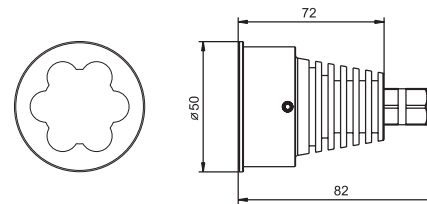
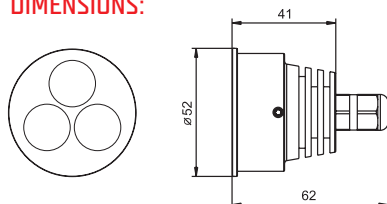



ArcSource 12

ArcSource 12 SmartWhite (AR1-11)

The Anolis ArcSource 12 combines state of the art lighting technology within an industry standard AR1-11 size fitting to create a truly specifier class lighting product. The highest quality optical system ensures that the desired effect can be achieved in the widest range of application possible. Utilising high powered Luxeon emitters the Anolis ArcSource 12 RGB is unsurpassed in performance, reliability and quality.



TECHNICAL SPECIFICATIONS:

ArcSource 12™

Max. input current:	350 mA
Maximum Power Consumption:	13.6 Watts
Compatible Power Supplies:	ArcPower 36, 72, 144, 360
Compatible Power Supplies for single colour variants:	ArcPower SW 36, 72, 144
Operating Ambient Temp.Range:	-20°C/+40°C
Operating Temperature:	+60°C @ ambient 25°C
Cooling System:	convection
Optical Systems Available:	6°, 15°, 25°, 38°
LED Device:	1 Watt Luxeon
Warm White LEDs (WW):	3300 K
Cool White LEDs (CW):	6500 K
Typical Lumen Maintenance:	70% @ 50.000 hours
Led Life Expectancy:	minimum 50.000 hours
Construction:	precision turned aluminium
Weight:	0.6 kg
Installation method:	standard AR1-11 housings
Ingress Protection:	IP 2X
Flammability:	94V-0 flame class rating
Power/Data plug:	RJ45
Power/Data cable:	24 AWG x 4P; category 5e

LED Colour Variants:

RGB, RGBWW, RGBCW, R, G, B, A, CW, WW, NW

ArcSource 12 SmartWhite™

Max. input current:	350 mA
Maximum Power Consumption:	13.6 Watts
Compatible Power Supplies:	ArcPower SW 36, 72, 144
Operating Ambient Temp.Range:	-20°C/+40°C
Operating Temperature:	+60°C @ ambient 25°C
Cooling System:	convection
Optical Systems Available:	6°, 15°, 25°, 38°
LED Device:	1 Watt Luxeon
Warm White LEDs (WW):	3300 K
Cool White LEDs (CW):	6500 K
Typical Lumen Maintenance:	70% @ 50.000 hours
Led Life Expectancy:	minimum 50.000 hours
Construction:	precision turned aluminium
Weight:	0.6 kg
Installation method:	standard AR1-11 housings
Ingress Protection:	IP 2X
Flammability:	94 V-0 flame class rating
Power/Data plug:	RJ45
Power/Data cable:	24 AWG x 4P; category 5e; 1.5m long

SW

DIMENSIONS:

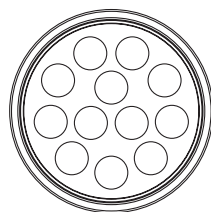
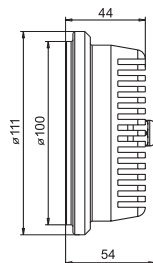



Woodchester Mansion, Stroud, The United Kingdom

ArcSource 3/K2, 12/K2

When extremely high light levels are required due to demanding ambient environments Luxeon K2 LED's can be added to most of the ArcSource Range. The latest edition to the Luxeon high power LED family brings unsurpassed performance to the Arc Source Range. With a variety of drive options available depending on the light output required the ArcSource K2 Range can now be applied to the most demanding application.



ArcSource

TECHNICAL SPECIFICATIONS:

Max. input current:
Maximum Power Consumption:
Compatible power supplies:
Compatible power supplies
for SW and single colour variants:
Light Source:
Led life expectancy:
Typical lumen maintenance:
Optical system available:
Housing:
Weight:
Cooling:
Ingress protection:
Flammability:
Ambient temp.range:
Power/Data plug:
Power/Data cable:

ArcSource 3/K2™

700mA
7.6 Watts
ArcPower 36/K2, ArcPower 72/K2

ArcPower SmartWhite 36/K2, 72/K2
3 x Luxeon K2
minimum 60.000 hours
70% @ 60.000 hours
6°, 15°, 25°, 38°
precision turned aluminium
0.25 kg
convection
IP 2X
94V-0 flame class rating
-20°C/+35°C
RJ45
24 AWG x 4P, category 5e, 1.5 m long

ArcSource 12/K2™

700mA
30 Watts
ArcPower 36/K2, ArcPower 72/K2

ArcPower SmartWhite 36/K2, 72/K2
12 x Luxeon K2
minimum 60.000 hours
70% @ 60.000 hours
6°, 15°, 25°, 38°
precision turned aluminium
0.6 kg
convection
IP 2X
94V-0 flame class rating
-20°C/+35°C
RJ45
type: 24 AWG x 4P, category 5e, 1.5 m long

LED Colour Variants:

RGB, R, G, B, WW, CW, NW

G, B, WW, CW, SW, NW

DIMENSIONS:

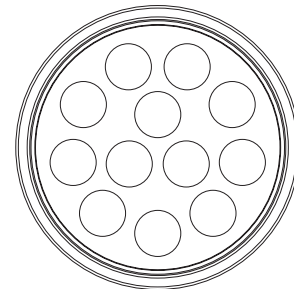
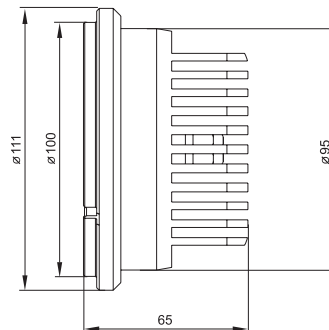
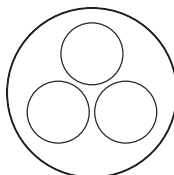
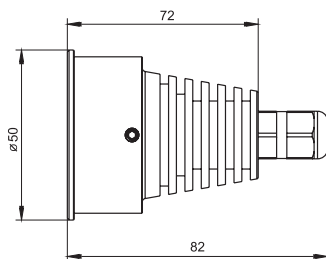



Ice Space, London, The United Kingdom

ArcSource Inground 3, 6, 7

The Anolis ArcSource Inground range brings the high standards of the ArcSource range to the world of exterior lighting. Industry standard Inground fittings with an IP rating of 67 combined with drive over load bearings allows the dramatic effects of ArcSource to be introduced to landscape illumination.



ArcSource

TECHNICAL SPECIFICATIONS:

	ArcSource Inground 3™	ArcSource Inground 6™	ArcSource Inground 7™
Max. input current:	350 mA	350 mA	350 mA
Maximum Power Consumption:	4.2 Watts	8.4 Watts	9.6 Watts
Compatible Power Supplies:	ArcPower 36, 72, 144, 360, 16x6	ArcPower 36, 72, 144, 360, 16x6	ArcPower 36, 72, 144, 360, 16x6
Compatible Power Supplies for single colour variants:	ArcPower SW 36, 72, 144	ArcPower SW 36, 72, 144	ArcPower SW 36, 72, 144
Operating Ambient Temp. Range:	-20°C/+30°C	-20°C/+30°C	-20°C/+30°C
Cooling System:	convection	convection	convection
Optical Systems Available:	6°, 15°, 25°, 38°	6°, 25°	6°, 25°
LED Device:	1 Watt Luxeon	1 Watt Luxeon	1 Watt Luxeon
Warm White LEDs (WW):	3300 K	3300 K	3300 K
Cool White LEDs (CW):	6500 K	6500 K	6500 K
Typical Lumen Maintenance:	70% @ 50.000 hours	70% @ 50.000 hours	70% @ 50.000 hours
Led Life Expectancy:	minimum 50.000 hours	minimum 50.000 hours	minimum 50.000 hours
Construction: top flange:	stainless steel	stainless steel	stainless steel
housing:	hardened aluminium	hardened aluminium	hardened aluminium
mounting sleeve:	plastic	plastic	plastic
transparent cover:	tempered glass	tempered glass	tempered glass
Top flange shapes:	round, square	round	round
Weight:	0.5 kg	1.2 kg	1.2 kg
Ingress Protection:	IP 67	IP 67	IP 67
IK rating:	IK 08	IK 07	IK 07
Power/Data plug:	RJ45	RJ45	RJ45
Power/Data cable:	Belden 7934A, cat. 5e; 1.5 m	Belden 7934A, cat. 5e; 1.5 m	Belden 7934A, cat. 5e; 1.5 m
LED Colour Variants:	R6B, R, G, B, A, CW, WW, NW	R6B, R6BCW, R6BWW, R, G, B, A, CW, WW, NW	R6BCW, R6BWW, R, G, B, A, CW, WW, NW

DIMENSIONS:

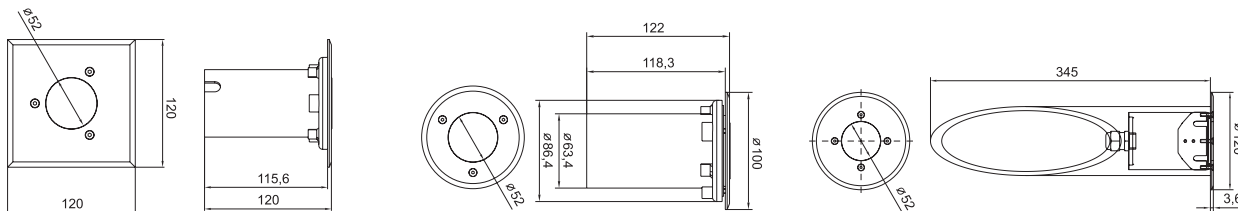



Somerset House, London, The United Kingdom (photo credits: Somerset House)

ArcSource Inground 12, 36

The Anolis ArcSource Inground 12 and ArcSource Inground 36 bring the option of an AR1-11 size LED fitting to the world of exterior lighting. IP67 rated and with drive over load bearings these inground fixtures are capable of meeting the most demanding of exterior applications. Building and feature illumination becomes a real possibility with Anolis ArcSource Inground 12 and ArcSource Inground 36.



TECHNICAL SPECIFICATIONS:

ArcSource Inground 12™

Max. input current:	350 mA
Maximum Power Consumption:	13.6 Watts
Compatible Power Supplies:	ArcPower 36, 72, 144, 360
Compatible Power Supplies for single colour variants:	ArcPower SmartWhite 36, 72, 144
Operating Ambient Temp.Range:	-20°C/+30°C
Cooling System:	convection
Optical Systems Available:	6°, 15°, 25°, 38°
LED Device:	1 Watt Luxeon
Warm White LEDs (WW):	3300 K
Cool White LEDs (CW):	6500 K
Typical Lumen Maintenance:	70% @ 50.000 hours
Led Life Expectancy:	minimum 50.000 hours
Construction: housing:	hardened aluminium
mounting sleeve:	plastic
transparent cover:	tempered glass
Top Flange shape:	round
Weight:	2 kg
Ingress Protection:	IP 67
IK rating:	IK 07
Power/Data plug:	RJ45
Power/Data cable:	Belden 7934A, cat. 5e; 1.5 meters long

LED Colour Variants: RGB, RGBWW, RGBCW, R, G, B, A, CW, WW, SW, NW

ArcSource Inground 36™

350 mA
40.8 Watts
ArcPower 36, 72, 144, 360
Compatible Power Supplies
ArcPower SmartWhite 36, 72, 144
-20°C/+30°C
convection
6°, 15°, 25°, 38°
1 Watt Luxeon
3300 K
6500 K
70% @ 50.000 hours
minimum 50.000 hours
hardened aluminium
plastic
tempered glass
round
3.6 kg
IP 67
IK 07
RJ45
Belden 7934A, cat. 5e; 1.5 meters long

LED Colour Variants: RGB, RGBWW, RGBCW, R, G, B, A, CW, WW, SW, NW

DIMENSIONS:

ArcSource Inground 12

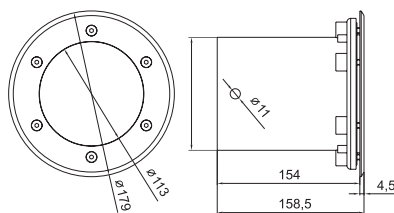

ArcSource Inground 36

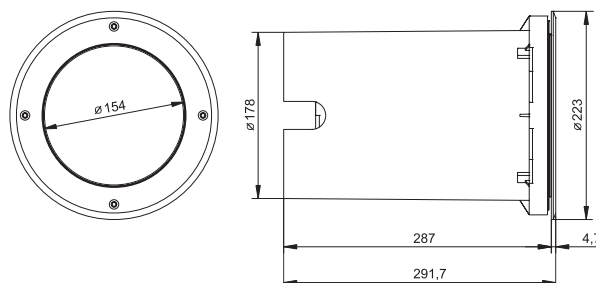



Fountain, Lidcombe, Sydney, Australia

ArcSource Outdoor 3, 6, 7

Manufactured from 316 stainless steel and with an IP rating of 68 the ArcSource Outdoor 3, 6, 7 make the perfect companion for the ArcSource Inground and ArcLine Outdoor products, The ArcSource Outdoor 3, 6, 7's high IP Rating allows the units to operate completely submerged in water, making illumination of water features a possibility. Power and Control for the ArcSource Outdoor range comes from the ArcPower 36, 72, 144, 360.



TECHNICAL SPECIFICATIONS:

	ArcSource Outdoor 3™	ArcSource Outdoor 6™	ArcSource Outdoor 7™
Max. input current:	350 mA	350 mA	350 mA
Maximum Power Consumption:	4.2 Watts	8.4 Watts	9.6 Watts
Compatible Power Supplies:	ArcPower 36, 72, 144, 360, 16x6	ArcPower 36, 72, 144, 360, 16x6	ArcPower 36, 72, 144, 360, 16x6
Compatible Power Supplies for single colour variants:	ArcPower SW 36, 72, 144	ArcPower SW 36, 72, 144	ArcPower SW 36, 72, 144
Operating Ambient Temp. Range:	-20°C/+30°C	-20°C/+30°C	-20°C/+30°C
Cooling System:	convection	convection	convection
Optical Systems Available:	6°, 15°, 25°, 38°	6°, 25°	6°, 25°
LED Device:	1 Watt Luxeon	1 Watt Luxeon	1 Watt Luxeon
Warm White LEDs (WW):	3300 K	3300 K	3300 K
Cool White LEDs (CW):	6500 K	6500 K	6500 K
Typical Lumen Maintenance:	70% @ 50.000 hours	70% @ 50.000 hours	70% @ 50.000 hours
Led Life Expectancy:	minimum 50.000 hours	minimum 50.000 hours	minimum 50.000 hours
Construction: top flange:	stainless steel	stainless steel	stainless steel
housing:	stainless steel	stainless steel	stainless steel
"U" bracket & screws:	stainless steel	stainless steel	stainless steel
transparent cover:	tempered glass	tempered glass	tempered glass
Top flange shapes:	round	round	round
Weight:	0.5 kg	0.6 kg	0.6 kg
Ingress Protection:	IP 68	IP 68	IP 68
IK rating:	IK 06	IK 06	IK 06
Power/Data plug:	RJ45	RJ45	RJ45
Power/Data cable:	Belden 7930A, Cat. 5e; 1.5 m	Belden 7930A, Cat. 5e; 1.5 m	Belden 7930A, Cat. 5e; 1.5 m
LED Colour Variants:	RGB, R, G, B, A, CW, WW, NW	RGBCW, RGBWW, RGB, R, G, B, A, CW, WW, NW	RGBCW, RGBWW, R, G, B, A, CW, WW, A, CW, WW, NW

DIMENSIONS:

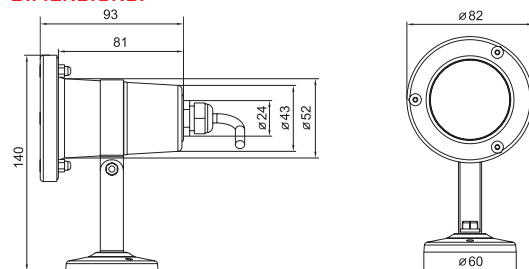



St Stephen's Church, Bath, The United Kingdom

ArcSource Outdoor 12, 36

When more output is required for outdoor applications the ArcSource Outdoor 12, 36 can be introduced. Once again manufactured from 316 stainless steel and with an IP rating of 68 the ArcSource Outdoor 12, 36 is at home either in or out of the water making it available to meet the requirements of the widest range of exterior lighting projects. Once again power and control is provided by ArcPower 36, 72, 144, 360.



TECHNICAL SPECIFICATIONS:

	ArcSource Outdoor 12™	ArcSource Outdoor 36™
Max. input current:	350 mA	350 mA
Maximum Power Consumption:	13.6 Watts	40.8 Watts
Compatible Power Supplies:	ArcPower 36, 72, 144, 360	ArcPower 36, 72, 144, 360
Compatible Power Supplies for single colour variants:	ArcPower SmartWhite 36, 72, 144	ArcPower SmartWhite 36, 72, 144
Operating Ambient Temp. Range:	-20°C/+30°C	-20°C/+30°C
Cooling System:	convection	convection
Optical Systems Available:	6°, 15°, 25°, 38°	6°, 15°, 25°, 38°
LED Device:	1 Watt Luxeon	1 Watt Luxeon
Warm White LEDs (WW):	3300 K	3300 K
Cool White LEDs (CW):	6500 K	6500 K
Typical Lumen Maintenance:	70% @ 50.000 hours	70% @ 50.000 hours
Led Life Expectancy:	minimum 50.000 hours	minimum 50.000 hours
Construction:	top flange housing "U" bracket & screws: transparent cover:	stainless steel stainless steel stainless steel stainless steel tempered glass
Weight:	1.7 kg	3.3 kg
Ingress Protection:	IP 68	IP 68
IK rating:	IK 07	IK 06
Power/Data plug:	RJ45	RJ45
Power/Data cable:	Belden 7930A, Cat. 5e; 1.5 m	Belden 7930A, Cat. 5e; 1.5 m
LED Colour Variants:	RGB, RGBWW, RGBCW, R, G, B, A, CW, WW, SW, NW	RGB, RGBWW, RGBCW, R, G, B, A, CW, WW, SW, NW

DIMENSIONS:

ArcSource Outdoor 12

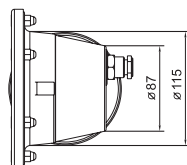
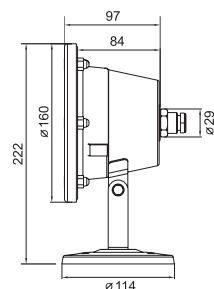

ArcSource Outdoor 36

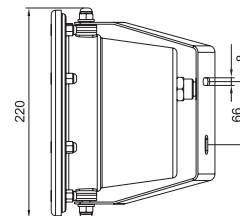
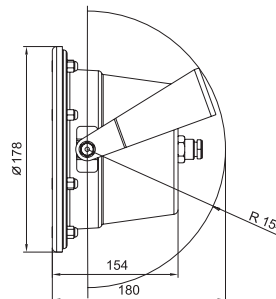



Mica Club, Rome, Italia

ArcSource Wall 3, Twin Wall 3

Finished in 316 stainless steel and with an IP rating of 54, the ArcSource Wall 3 RGB brings full colour mixing to a compact wall mounted fitting, using high powered Luxeon LED's the unit can be used to up light or down light from a wall mounted position making the unit ideal when recessed fittings are not possible.

As well as colour mixing from the RGB source the Anolis ArcSource Wall 3 can also be fitted with either warm white 3300 K or cold white 6500 K high powered Luxeon LED's making it the ideal alternative to conventional low voltage halogen wall lights.



TECHNICAL SPECIFICATIONS:

	ArcSource Wall 3™	ArcSource Twin Wall 3™
Max. input current:	350 mA	350 mA
Maximum Power Consumption:	4.2 Watts	8.4 Watts
Compatible Power Supplies:	ArcPower 36, 72, 144, 360, 16x6	ArcPower 36, 72, 144, 360, 16x6
Compatible Power Supplies for single colour variants:	ArcPower SmartWhite 36, 72, 144	ArcPower SmartWhite 36, 72, 144
Operating Ambient Temp. Range:	-20°C/+30°C	-20°C/+30°C
Cooling System: convection convection		
Optical Systems Available:	6°, 15°, 25°, 38°	6°, 15°, 25°, 38°
LED Device:	1 Watt Luxeon	1 Watt Luxeon
Warm White LEDs (WW):	3300 K	3300 K
Cool White LEDs (CW):	6500 K	6500 K
Typical Lumen Maintenance:	70% @ 50.000 hours	70% @ 50.000 hours
Led Life Expectancy:	minimum 50.000 hours	minimum 50.000 hours
Construction: top flange:	stainless steel	stainless steel
housing:	stainless steel	stainless steel
transparent cover:	tempered glass	tempered glass
Weight:	0.7 kg	1.2 kg
Ingress Protection:	IP 54	IP 54
IK rating:	IK 05	IK 05
Power/Data plug:	RJ45	RJ45
Power/Data cable:	Belden 7930A, Cat. 5e; 1.5 m	Belden 7930A, Cat. 5e; 1.5 m
LED Colour Variants:	RGB, R, G, B, A, CW, WW, NW	RGB, R, G, B, A, CW, WW, NW

DIMENSIONS:

ArcSource Wall 3

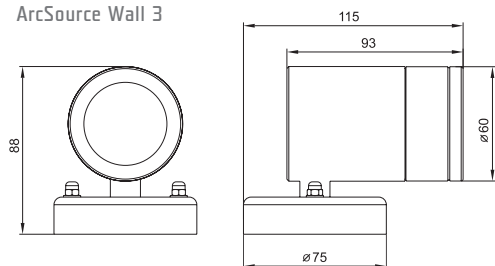

ArcSource Twin Wall 3

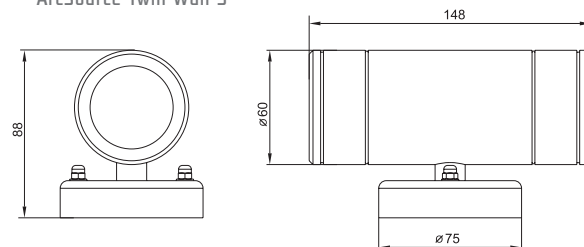



Tabu Bar, Budapest, Hungary (photo credits: Colossal Sound)

ArcLink 3, 4, ArcLink Optic 3, 4

The perfect companion to the ArcLine range ArcLink adds a flexible dimension to linear LED lighting combining the latest Luxeon high powered LED's with simple CAT 5 connection and complete with heat sink for thermal management the compact ArcLink can be installed virtually anywhere, including curved alcove lighting and even concealed within furniture or fittings



TECHNICAL SPECIFICATIONS:

	ArcLink 3™	ArcLink Optic 3™	ArcLink 4™	ArcLink Optic 4™
Max. input current:	350 mA	350 mA	350 mA	350 mA
Maximum Power Consumption:	3.4 Watts	3.4 Watts	4.5 Watts	4.5 Watts
Compatible Power Supplies:	ArcPower 36, 72, 144, 360, 16x6	ArcPower 36, 72, 144, 360, 16x6	ArcPower 36, 72, 144, 360	ArcPower 36, 72, 144, 360
Compatible Power Supplies for single colour variants:	ArcPower SmartWhite 36, 72, 144	ArcPower SmartWhite 36, 72, 144	ArcPower SmartWhite 36, 72, 144	ArcPower SmartWhite 36, 72, 144
Operating Ambient Temp. Range:	-20°C/+40°C	-20°C/+40°C	-20°C/+40°C	-20°C/+40°C
Operating Temperature:	+50°C @ ambient 25°C	+50°C @ ambient 25°C	+50°C @ ambient 25°C	+50°C @ ambient 25°C
Cooling System:	convection	convection	convection	convection
Optical System:	170°	6°, 15°, 25°, 25°x6°, 38°	170°	6°, 15°, 25°, 25°x6°, 38°
LED Device:	1 Watt Luxeon	1 Watt Luxeon	1 Watt Luxeon	1 Watt Luxeon
Warm White LEDs (WW):	3300 K	3300 K	3300 K	3300 K
Cool White LEDs (CW):	6500 K	6500 K	6500 K	6500 K
Typical Lumen Maintenance:	70% @ 50.000 hours	70% @ 50.000 hours	70% @ 50.000 hours	70% @ 50.000 hours
Led Life Expectancy:	minimum 50.000 hours	minimum 50.000 hours	minimum 50.000 hours	minimum 50.000 hours
Construction:	aluminium base	aluminium base	aluminium base	aluminium base
Weight:	0.05 kg	0.05 kg	0.05 kg	0.06 kg
Power/Data plug:	RJ45	RJ45	RJ45	RJ45
Accessories:	patch cables, termination plug	patch cables, termination plug	patch cables, termination plug	patch cables, termination plug
LED Colour Variants:	RGB, WWACW, WWAWW, CW, WW, R, G, B, A, NW	RGB, WWACW, WWAWW, CW, WW, R, G, B, A, NW	RGBWW, RGBCW, RGB, R, G, B, CW, WW, SW, NW	RGBWW, RGBCW, RGB, R, G, B, CW, WW, NW

DIMENSIONS:

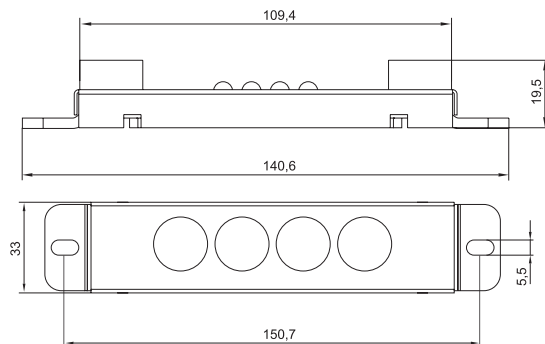
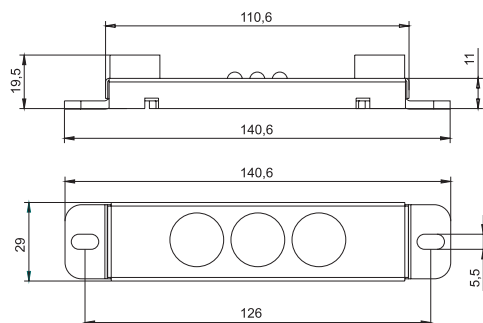



Grand Ballroom of the Merrimu Reception Centre, Melbourne, Australia

ArcLine 12, 18, 24, 36

The Anolis ArcLine combines state of the art lighting technology with a balanced design profile to create truly specifier class lighting systems. Using only the finest materials and precision manufacturing techniques the Anolis ArcLine provides the professional solution for your lighting requirements. The highest quality wide angle LEDs ensures that a constant effect is delivered in the widest range of application possibilities. Utilizing high powered Luxeon Emitters the Anolis ArcLine is unsurpassed in performance, reliability and quality.



ArcLine

TECHNICAL SPECIFICATIONS:

	12 ArcLine™	18 ArcLine™	24 ArcLine™	36 ArcLine™
Max. input current:	350 mA	350 mA	350 mA	350 mA
Maximum Power Consumption:	13.6 Watts	20.4 Watts	27.2 Watts	40.8 Watts
Compatible Power Supplies:	ArcPower 36, 72, 144, 360	ArcPower 36, 72, 144, 360	ArcPower 36, 72, 144, 360	ArcPower 36, 72, 144, 360
Compatible Power Supplies for single colour variants:	ArcPower SW 36, 72, 144	ArcPower SW 36, 72, 144	ArcPower SW 36, 72, 144	ArcPower SW 36, 72, 144
Operating Ambient Temp.Range:	-20°C/+40°C	-20°C/+40°C	-20°C/+40°C	-20°C/+40°C
Operating Temperature:	+50°C @ ambient 25°C	+50°C @ ambient 25°C	+50°C @ ambient 25°C	+50°C @ ambient 25°C
Cooling System:	convection	convection	convection	convection
Optical System:	170°	170°	170°	170°
LED Device:	1 Watt Luxeon	1 Watt Luxeon	1 Watt Luxeon	1 Watt Luxeon
Warm White LEDs (WW):	3300 K	3300 K	3300 K	3300 K
Cool White LEDs (CW):	6500 K	6500 K	6500 K	6500 K
Typical Lumen Maintenance:	70% @ 50.000 hours	70% @ 50.000 hours	70% @ 50.000 hours	70% @ 50.000 hours
Led Life Expectancy:	minimum 50.000 hours	minimum 50.000 hours	minimum 50.000 hours	minimum 50.000 hours
Construction:	precision extruded aluminium	precision extruded aluminium	precision extruded aluminium	precision extruded aluminium
Weight:	0.6 kg	0.8 kg	1.0 kg	1.5 kg
Power/data cable connection:	rear or side	rear or side	rear or side	rear or side
Installation method:	integral universal mounting system	integral universal mounting system	integral universal mounting system	integral universal mounting system
Ingress Protection:	IP 2X	IP 2X	IP 2X	IP 2X
Flammability:	94HB flame class rating	94HB flame class rating	94HB flame class rating	94HB flame class rating
Power/Data plug:	RJ45	RJ45	RJ45	RJ45
Power/Data cable:	24 AWG x 4P; category 5e; 1.5 m long	24 AWG x 4P; category 5e; 1.5 m long	24 AWG x 4P; category 5e; 1.5 m long	24 AWG x 4P; category 5e; 1.5 m long
LED Colour Variants:	RGB, R, G, B, A, CW, WW, NW	RGB, R, G, B, A, CW, WW, NW	RGB, R, G, B, A, CW, WW, NW	RGB, R, G, B, A, CW, WW, NW

Other dimensional and colour variants on request.

DIMENSIONS:

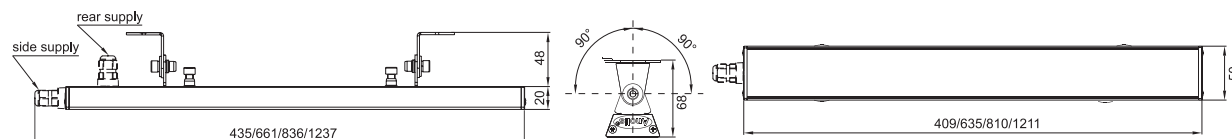



Private House, Sovereign Island, Gold Coast, Australia

ArcLine Optic 12, 18, 24, 36

The Anolis ArcLine Optic range combines state of the art lighting technology with a balanced design profile to create truly specifier class lighting systems. Using only the finest materials and precision manufacturing techniques the Anolis ArcLine provides the professional solution for your lighting requirements.

The highest quality wide angle LEDs ensures that a constant effect is delivered in the widest range of applications possibilities. Utilizing high powered Luxeon Emitters the Anolis ArcLine Optic range is unsurpassed in performance, reliability and quality.



ArcLine

TECHNICAL SPECIFICATIONS:

	12 ArcLine™	18 ArcLine™	24 ArcLine™	36 ArcLine™
Max. input current:	350 mA	350 mA	350 mA	350 mA
Maximum Power Consumption:	13.6 Watts	20.4 Watts	27.2 Watts	40.8 Watts
Compatible Power Supplies:	ArcPower 36, 72, 144, 360	ArcPower 36, 72, 144, 360	ArcPower 36, 72, 144, 360	ArcPower 36, 72, 144, 360
Compatible Power Supplies for single colour variants:	ArcPower SW 36, 72, 144	ArcPower SW 36, 72, 144	ArcPower SW 36, 72, 144	ArcPower SW 36, 72, 144
Operating Ambient Temp.Range:	-20°C/+40°C	-20°C/+40°C	-20°C/+40°C	-20°C/+40°C
Operating Temperature:	+50°C @ ambient 25°C	+50°C @ ambient 25°C	+50°C @ ambient 25°C	+50°C @ ambient 25°C
Cooling System:	convection	convection	convection	convection
Optical System:	6°, 15°, 25°, 25°x6°, 38°	6°, 15°, 25°, 25°x6°, 38°	6°, 15°, 25°, 25°x6°, 38°	6°, 15°, 25°, 25°x6°, 38°
LED Device:	1 Watt Luxeon	1 Watt Luxeon	1 Watt Luxeon	1 Watt Luxeon
Warm White LEDs (WW):	3300 K	3300 K	3300 K	3300 K
Cool White LEDs (CW):	6500 K	6500 K	6500 K	6500 K
Typical Lumen Maintenance:	70% @ 50.000 hours	70% @ 50.000 hours	70% @ 50.000 hours	70% @ 50.000 hours
Led Life Expectancy:	minimum 50.000 hours	minimum 50.000 hours	minimum 50.000 hours	minimum 50.000 hours
Construction:	precision extruded aluminium	precision extruded aluminium	precision extruded aluminium	precision extruded aluminium
Weight:	0.75 kg	1.05 kg	1.3 kg	1.9 kg
Power/data cable connection:	rear or side	rear or side	rear or side	rear or side
Installation method:	integral universal mounting system	integral universal mounting system	integral universal mounting system	integral universal mounting system
Ingress Protection:	IP 2X	IP 2X	IP 2X	IP 2X
Flammability:	94HB flame class rating	94HB flame class rating	94HB flame class rating	94HB flame class rating
Power/Data plug:	RJ45	RJ45	RJ45	RJ45
Power/Data cable:	24 AWG x 4P; category 5e; 1.5 m long	24 AWG x 4P; category 5e; 1.5 m long	24 AWG x 4P; category 5e; 1.5 m long	24 AWG x 4P; category 5e; 1.5 m long
LED Colour Variants:	RGB, R, G, B, A, CW, WW, NW	RGB, R, G, B, A, CW, WW, NW	RGB, R, G, B, A, CW, WW, NW	RGB, R, G, B, A, CW, WW, NW

Other dimensional and colour variants on request.

DIMENSIONS:

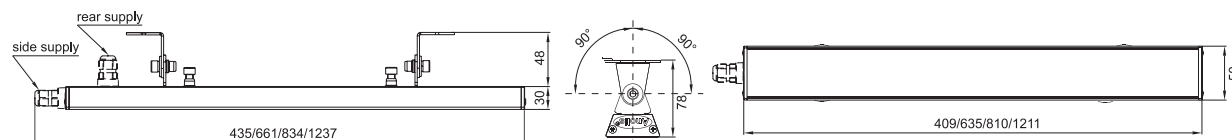



Industrie & Handels-Kammer Building, Braunschweig, Germany

ArcLine Optic 12, 24, 36 SmartWhite

When colour rendering is of high importance the ArcLine Optic Smart White provides the solution combining both warm white and cold white high powered Luxeon LED's with Anolis digital control a full range of white light from 3200K to 6500K can be achieved.

All this technology is combined with the balanced design profile of the Anolis ArcLine Optic with the highest quality optics to create truly versatile linear lighting system whatever the environment demands.



TECHNICAL SPECIFICATIONS:

	ArcLine Optic 12 SmartWhite™	ArcLine Optic 24 SmartWhite™	ArcLine Optic 36 SmartWhite™
Max. input current:	350 mA	350 mA	350 mA
Maximum Power Consumption:	13.6 Watts	27.2 Watts	40.8 Watts
Compatible Power Supplies:	ArcPower SW 36, 72, 144	ArcPower SW 36, 72, 144	ArcPower SW 36, 72, 144
Operating Ambient Temp. Range:	-20°C/+40°C	-20°C/+40°C	-20°C/+40°C
Operating Temperature:	+50°C @ ambient 25°C	+50°C @ ambient 25°C	+50°C @ ambient 25°C
Cooling System:	convection	convection	convection
Optical System:	6°, 15°, 25°, 25°x6°, 38°	6°, 15°, 25°, 25°x6°, 38°	6°, 15°, 25°, 25°x6°, 38°
LED Device:	1 Watt Luxeon	1 Watt Luxeon	1 Watt Luxeon
Warm White LEDs:	3300 K	3300 K	3300 K
Cool White LEDs:	6500 K	6500 K	6500 K
Typical Lumen Maintenance:	70% @ 50.000 hours	70% @ 50.000 hours	70% @ 50.000 hours
Led Life Expectancy:	minimum 50.000 hours	minimum 50.000	minimum 50.000
Construction:	precision extruded aluminium	precision extruded aluminium	precision extruded aluminium
Weight:	0.75 kg	1.3 kg	1.9 kg
Power/data cable connection:	rear or side	rear or side	rear or side
Installation method:	integral universal mounting system	integral universal mounting system	integral universal mounting system
Ingress Protection:	IP 2X	IP 2X	IP 2X
Flammability:	94HB flame class rating	94HB flame class rating	94HB flame class rating
Power/Data plug:	RJ45	RJ45	RJ45
Power/Data cable:	24 AWG x 4P; category 5e; 1.5 m long	24 AWG x 4P; category 5e; 1.5 m long	24 AWG x 4P; category 5e; 1.5 m long

LED Colour Variants:

SW

SW

SW

Other dimensional and colour variants on request.

DIMENSIONS:

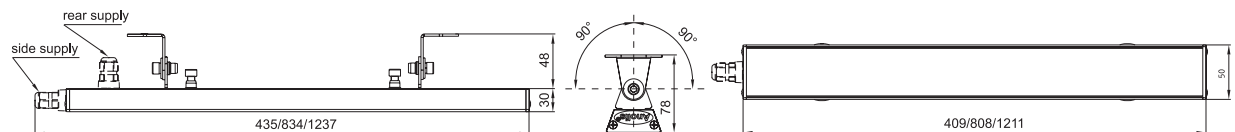



Casino at Leicester Square, London, The United Kingdom

ArLine

TECHNICAL SPECIFICATIONS:

ArcLine Outdoor Optic 36™
ArcLine Double Outdoor Optic 72™

Max. input current per colour:	350 mA	350 mA	350 mA
Maximum Power Consumption:	20.4 Watts	27.2 Watts	40.8 Watts
	<i>40.8 Watts</i>	<i>54.4 Watts (27.2 W per line)</i>	<i>81.6 Watts (40.8 W per line)</i>
Total Number of LEDs:	18	24	36
	<i>2x18</i>	<i>2x24</i>	<i>2x36</i>
Compatible Power Supplies:	ArcPower 36, 72, 144, 360	ArcPower 36, 72, 144, 360	ArcPower 36, 72, 144, 360
	<i>ArcPower 36, 72, 144, 360</i>	<i>ArcPower 36, 72, 144, 360</i>	<i>ArcPower 36, 72, 144, 360</i>
Compatible Power Supplies for smart white and single colour variants:	ArcPower SmartWhite 36, 72, 144	ArcPower SmartWhite 36, 72, 144	ArcPower SmartWhite 36, 72, 144
Operating Ambient Temp. Range:	-20°C/+40°C	-20°C/+40°C	-20°C/+40°C
Cooling System:	convection	convection	convection
Optical Systems Available:	6°, 15°, 25°, 25°x6°, 38°	6°, 15°, 25°, 25°x6°, 38°	6°, 15°, 25°, 25°x6°, 38°
LED Device:	1 Watt Luxeon	1 Watt Luxeon	1 Watt Luxeon
Typical Lumen Maintenance:	70% @ 50.000 hours	70% @ 50.000 hours	70% @ 50.000 hours
Led Life Expectancy:	minimum 50.000 hours	minimum 50.000 hours	minimum 50.000 hours
Construction: body:	precision extruded aluminium	precision extruded aluminium	precision extruded aluminium
“U” holder:	zincing steel	zincing steel	zincing steel
transparent cover:	tempered glass	tempered glass	tempered glass
Weight:	3.1 kg	4.3 kg	6.4 kg
	<i>4.6 kg</i>	<i>5.8 kg</i>	<i>8.5 kg</i>
Ingress Protection:	IP 65	IP 65	IP 65
IK rating:	IK 07	IK 07	IK 07
	<i>IK 06</i>	<i>IK 06</i>	<i>IK 06</i>
Power/Data plug:	RJ45	RJ45	RJ45
Power/Data cable:	Belden 7930A, Cat. 5e; 1.5 m	Belden 7930A, Cat. 5e; 1.5 m	Belden 7930A, Cat. 5e; 1.5 m
LED Colour Variants:	RGB, R, G, B, A, CW, WW, NW	RGB, R, G, B, A, CW, WW, SW, NW	RGB, R, G, B, A, CW, WW, SW, NW

Other dimensional and colour variants on request.

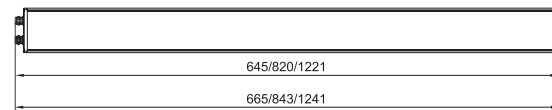



Gold Coast Convention & Exhibition Centre - Gold Coast, Queensland.



ArcPAR 3, 12

Anolis ArcPar 3/12 brings the latest high technology LED light source to the universally accepted formats of MR16 and PAR 36, for retail or entertainment applications the ArcPar 3/12 are a complete ready to mount package. Finished in the highest quality powder coating and available in 3 colours Black, White or Silver the ArcPower 12 can add the latest technology in a conventional format to a wide variety of applications.



TECHNICAL SPECIFICATIONS:

Max. input current:
Maximum Power Consumption:
Compatible Power Supplies:
Compatible Power Supplies
for single colour variants:
Operating Ambient Temp. Range:
Operating Temperature:
Cooling System:
Optical Systems Available:
LED Device:
Warm White LEDs (WW):
Cool White LEDs (CW):
Typical Lumen Maintenance:
Led Life Expectancy:
Construction: housing:
 "U" bracket:
 transparent cover:
 finish:
Weight:
Ingress Protection:
Power/Data plug:
Power/Data cable:

ArcPAR 3™

350 mA
4.2 Watts
ArcPower 36, 72, 144, 360, 16x6

ArcPower SW 36, 72, 144
-20°C/+40°C
+55°C @ ambient 25°C
convection
6°, 15°, 25°, 38°
1 Watt Luxeon
3300 K
6500 K
70% @ 50.000 hours
minimum 50.000 hours
precision extruded aluminium
steel
tempered glass
black, white, silver
0.5 kg
IP 2X
RJ45
24 AWG x 4P; category 5e

LED Colour Variants:

RGB, R, G, B, A, CW, WW, NW

ArcPAR 12™

350 mA
13.6 Watts
ArcPower 36, 72, 144, 360

ArcPower SW 36, 72, 144
-20°C/+40°C
+60°C @ ambient 25°C
convection
6°, 15°, 25°, 38°
1 Watt Luxeon
3300 K
6500 K
70% @ 50.000 hours
minimum 50.000 hours
precision extruded aluminium
aluminium plate
tempered glass
black, white, silver
1.5 kg
IP 2X
RJ45
24 AWG x 4P; category 5e

RGB, RGBWW, RGBCW, R, G, B, A, CW, WW, NW

DIMENSIONS:

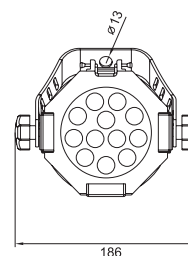
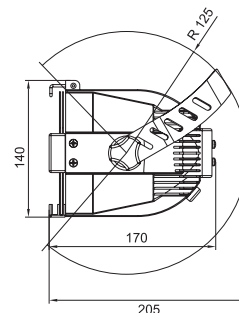
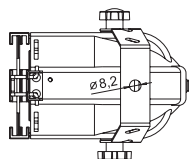
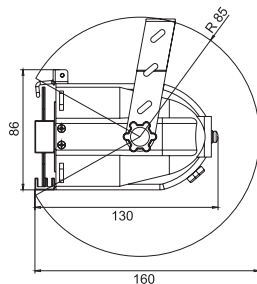



College Michel-de-Swaen, Dunkerque, France

ArcPad 48, ArcPad 48 Integral

The ArcPad 48 and ArcPad 48 Integral are designed for the generation of rich, saturated colours and colour changing effects in wall-washing, spot lighting, and large alcove lighting in many architectural applications.

The ArcPad 48 is a durable and robust fixture with a projected lifespan of minimum 60.000 hours. The base of the fixture is made from a cast metal and it is built for floor or wall mounting via two holes in the base. The fixture's head is made up of a radiator (cast aluminium), on which the LED matrix and lenses are fitted. The head can be moved in relation to the base in ranges: pan +45°/-45°, tilt +60°/-90°.

The ArcPad 48 Integral is a compact version of the ArcPad 48. The base of the fixture includes an inbuilt Power Supply and an Intelligent LED driver. This format provides a solution that simplifies both the cabling and the installation of the ArcPad 48 Integral.



TECHNICAL SPECIFICATIONS:

	ArcPower 48™	ArcPower 48 Integral™
Light source:	48 RGBW LEDs	48 RGBW LEDs
Led device:	Luxeon Rebel	Luxeon Rebel
Available optical systems:	standard 25°, optional 12°, 45° and 45°x15°	standard 25°, optional 12°, 45° and 45°x15°
Typical Lumen maintenance:	70% @ 60.000 hours	70% @ 60.000 hours
LED life expectancy:	minimum 60.000 hours	minimum 60.000 hours
Power supply:	external	on-board
Compatible power supply:	ArcPower 48	---
Input voltage:	---	100-240 V AC, 50/60 Hz, electronic auto-ranging
Construction: Housing:	cast aluminium	cast aluminium
Transparent cover:	flat tempered glass	flat tempered glass
"tilt" range:	150°	120°
"pan" range:	90°	35°
Weight:	1.8 kg	2.4 kg
Ingress protection:	IP 67	IP 67
IK rating:	IK 06	IK 06
Cooling system:	convection	convection
Surface operating temperature:	+70°C @ ambient 25°C	+70°C @ ambient 25°C
Operating ambient temp. range:	-20°C/+40°C	-20°C/+40°C
Power/Data Connection plug:	RJ45	power/data cable junction box
Power/Data Connection cable:	Belden Cable 7930A Paired-Pata Tuff Cat. 5e, AWG 24	---
Maximum Power Consumption:	---	60W
Control:	---	USITT DMX 512 (RDM support), DyNet
Setting & addressing:	---	via RDM protocol
DMX channels:	---	3, 4, 6, 7
DMX protocol modes:	---	5
LED Colour Variants:	RGB WW, WW, CW, SW	RGB WW, WW, CW, SW

DIMENSIONS:

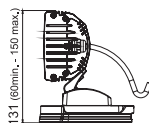
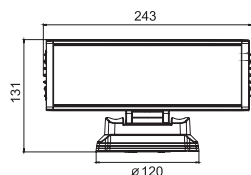



Dunkerque Littoral Pole de Valorisation des Dechets, France

ArcPad Xtreme

ArcPad Xtreme is a special outdoor fixture with two independent LED modules. LEDs are densely populated, providing extremely bright light output. The fixture is completely silent due to the conventional cooling. The IP 67 rating means it can be used for exterior installations.

ArcPad Xtreme is an ideal fixture for illuminating large buildings and stages, thanks to the high light output of the LED modules. The unique combination of RGBW LED colours delivers a stunning quality of white light, not seen in other competitive products on the market.



ArcPad

TECHNICAL SPECIFICATIONS:

ArcPad Xtreme™

Light source:	188 RGBW LEDs
LED device:	Luxeon K2
Number of LED modules:	2
Typical Lumen Maintenance:	70% @ 60.000 hours
Available Optical Systems:	Standard 25°, optional 12°, 45° and 45x15°
Led life expectancy:	minimum 60.000 hours
Power supply:	on-board
Input voltage:	100-240 V AC, 50/60 Hz, electronic auto-ranging
Maximum Power Consumption:	650 W
Control:	USITT DMX 512 (RDM support), Dynet
Setting & addressing:	via RDM protocol
DMX channels:	4, 8, 12
DMX protocol modes:	4
Housing:	die-cast aluminium
Mounting bracket:	steel
Transparent cover:	flat tempered glass
Weight:	52kg
Ingress Protection:	IP 67
Mounting bracket position range:	-180°/+180°
LED module position range :	-5°/+95° (each LED module)
Connection:	power/data cable with junction box
Cooling system:	convection
Ambient temperature range:	-20°C/+40°C

LED Colour Variants:

RGBCW

DIMENSIONS:

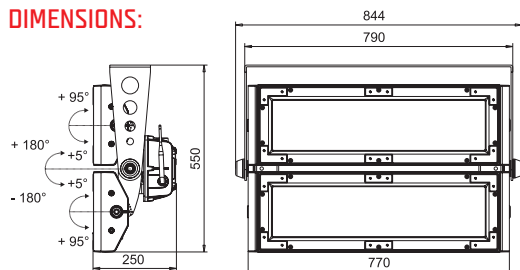



Izamal Convent, Mexico

ArcSource 96 Integral

The Anolis ArcSource 96 Integral is the latest addition to the comprehensive range of Anolis LED lighting projectors. Using the advanced technology of the highly successful ArcPAD 48 the ArcSource 96 Integral brings even more power and light output that is often required by today's demanding lighting projects. Housed in compact IP65 rated aluminium housing, the 96 high brightness Rebel LED's provide unbelievable light output previously unavailable in an LED fixture of this size. Control is via DMX/RDM allowing for advanced programming options, latest technology electronics ensure stable white balance is achieved as well as a minimum life expectancy of 60.000 hours.

Available in a variety of colour options including RGB/CW, RGB/WW, RGB/A as well as CW and WW the ArcSource 96 Integral is a truly versatile fixture that can be specified in the most demanding of interior and exterior lighting schemes.

TECHNICAL SPECIFICATIONS:

Light source:	96 RGBW LEDs
LED device:	Luxeon Rebel
Available optical systems:	Standard 25°, optional 12°, 45° and 45x15°
Typical Lumen Maintenance:	70% @ 60.000 hours
Led Life Expectancy:	minimum 60.000 hours
Power supply:	on-board
Input voltage:	100-240 V AC, 50/60 Hz, electronic auto-ranging
Maximum Power Consumption:	180 W
Control:	USITT DMX 512 (RDM support), Dynet
Setting & addressing:	4-digit LED display & 4 control buttons
DMX channels:	12, 11, 8, 4,
DMX protocol modes:	5
Housing:	die-cast aluminium
Mounting bracket:	hard aluminium
Transparent cover:	flat tempered glass
Weight:	11 kg
Ingress Protection:	IP67
Mounting bracket position range:	+180°/-180°
Connection:	power/data cable with junction box
Cooling system:	convection
Ambient temperature range:	-20°C/+40°C

LED Colour Variants:

RGBCW, RGBWW, RGBA, CW, WW

DIMENSIONS:

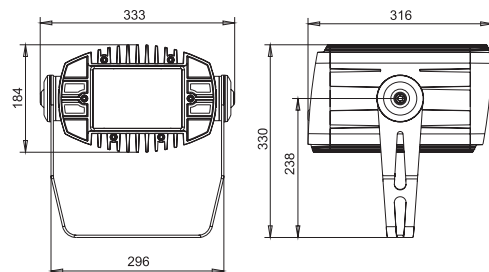



ArcWash 236, ArcWash Recessed 236

Combining a total of 36 high powered K2 Luxeon LED'S and a state of the art moving head luminaire the ArcWash 236 brings the dimension of movement to LED wash lighting. Combining movement with full colour mixing allows for effect to be created that would be impossible from a fixed head fitting. With built in power supply, direct control via DMX, 530 degree pan movement and a tilt range of 280 degrees effects the ArcWash 236 is able to respond to the most demanding of installations.

With its compact mounting box the ArcWash 236 Recessed allows moving light fixtures to be fitted where in the past there has simply been no space for such a fixture



TECHNICAL SPECIFICATIONS:

ArcWash 236™

Input Voltage:	100-240 V AC, 50/60 Hz
Maximum Power Consumption:	180 VA
Light source:	36 x K2 Luxeon LED's (12 Red, 12 Green, 12 Blue)
Optical system:	6° standard, 25° optional beam angle 2 additional frost filters included pre-programmed colours and rainbow effect white balance pre-programmed via LED control panel
Colours:	electronic dimming 0-100% strobe effect max. 25 fps
Dimmer/Strobe:	
Pan:	530°
Tilt:	280°
Pan/Tilt resolution:	8 or 16 bit
Protocol:	USITT DMX 512
Control channels:	8 or 14
Control Options:	DMX, Auto-trigger, Audio-trigger
Operation modes:	DMX, Master/slave, Stand-alone
Display:	4-digit LED
Programs:	6 built-in programs, 3 user editable programs up to 30 steps each locking 3-pin XLR
Data in/out:	40°C
Max. ambient oper. temperature:	2 pairs of 1/4 -turn locks
Mounting points:	2 x Omega holders
Fastening system:	8.8 kg
Weight:	2 frost filters, 2 Omega holders
Accessories:	
Ceiling box variants:	

ArcWash Recessed 236™

Input Voltage:	100-240 V AC, 50/60 Hz
Maximum Power Consumption:	180 VA
Light source:	36 x K2 Luxeon LED's (12 Red, 12 Green, 12 Blue)
Optical system:	6° standard, 25° optional beam angle 2 additional frost filters included pre-programmed colours and rainbow effect white balance pre-programmed via LED control panel
Colours:	electronic dimming 0-100% strobe effect max. 25 fps
Dimmer/Strobe:	
Pan:	530°
Tilt:	280°
Pan/Tilt resolution:	8 or 16 bit
Protocol:	USITT DMX 512
Control channels:	8 or 14
Control Options:	DMX, Auto-trigger, Audio-trigger
Operation modes:	DMX, Master/slave, Stand-alone
Display:	4-digit LED
Programs:	6 built-in programs, 3 user editable programs up to 30 steps each locking 3-pin XLR
Data in/out:	40°C
Max. ambient oper. temperature:	4 mounting slots
Mounting points:	ceiling box
Fastening system:	8.8 kg (moving head), 7 kg ceiling box
Weight:	2 frost filters
Accessories:	600 x 600 mm grid, 625 x 625 mm grid and version for plaster-boards
Ceiling box variants:	

DIMENSIONS:

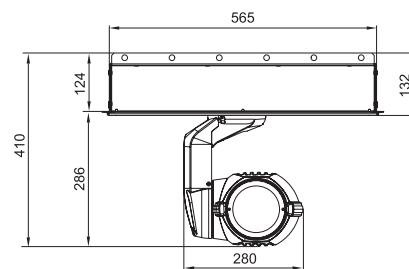
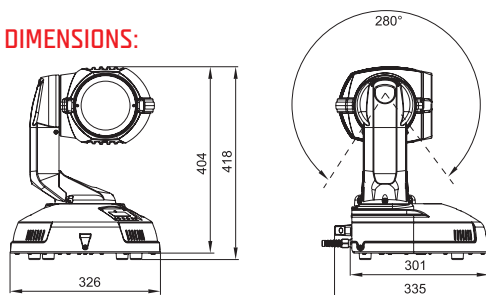



Ice Space, London, The United Kingdom

ArcPower 9, 12

Anolis ArcPower 9 & 12 provide the perfect complement to the existing ArcPower range, specifically designed for installation where no DMX control or dimming is required the Anolis ArcSource 9 & 12 provides both a simple and economical power solution for a variety of the high quality Anolis ArcSource range. Installations of single colour ArcSource products now have the ideal power solution. Manufactured from the highest quality materials to the same high standards as the rest of the Anolis range ArcPower range, the ArcPower 9 & 12 brings a new dimension to single colour installations.



TECHNICAL SPECIFICATIONS:

ArcPower 9™

Input Voltage:	110-240 V AC, 50/60 Hz
Designed for:	Single colour variants of ArcLink/Optic 3, 4; ArcSource 3, 6, 7; ArcSource Outdoor 3, 6, 7; ArcSource Wall/TwinWall 3; ArcSource Inground 3, 6, 7; ArcLine Outdoor Optic 6; ArcPar 3; ArcLine Optic 3, 6; ArcSource 3/K2
Max. load:	9 x 1.2 W LEDs (e.g. 3 x ArcSource 3 or 1 x ArcSource 6 + 1 x ArcSource 3) 4 x 3 W LEDs (e.g. 1 x ArcSource 3/K2)
Protections:	Thermal, short circuit, over voltage and open circuit
Power connection:	Screw terminals
LED output connection:	Screw terminals
Max. housing temperature:	<85°C
Ambient operating Temperature range:	-20°C/ +45°C
Colour:	Grey
Dimensions:	99 x 39 x 23.5 mm
Weight:	70 g

ArcPower 12™

Input Voltage:	230/240 V AC, 50/60 Hz
Designed for:	Single colour variants of the ArcSource 12 only
Max. load:	1 x ArcSource 12
Protections:	Thermal, short circuit, over voltage and open circuit
Power connection:	Screw terminals
LED output connection:	Screw terminals
Max. housing temperature:	<85°C
Ambient operating Temperature range:	-20°C/ +40°C
Colour:	Grey
Dimensions:	111 x 52 x 24 mm
Weight:	105 g



Mentone Hotel, Melbourne, Australia

ArcPower 36, 72, 144, 360

The Anolis range of LED lighting fixtures is brought to life with power and control via the ArcPower range. Manufactured from only the highest quality components the ArcPower range produces both the performance and reliability required for modern lighting solutions. Using industry standard protocols such as DMX 512 and RS232 along with globally recognised RJ45 connectors the ArcPower range is the lighting designer's perfect solution.



ArcPower

TECHNICAL SPECIFICATIONS:

	ArcPower 36™	ArcPower 72™	ArcPower 144™	ArcPower 360™
Input Voltage:	100-240 V AC, 50/60 Hz	100-240 V AC, 50/60 Hz	100-240 V AC, 50/60 Hz	100-240 V AC, 50/60 Hz
Maximum Power Consumption:	60 W	120 W	240 W	600 W
Number of LED output zones:	1	2	4	10
Max. Output current:	350 mA per colour	350 mA per colour	350 mA per colour	350 mA per colour
Max. load per zone:	36 x 1 W LED's in RGB mode 42 x 1 W LED's in RGBW mode	36 x 1 W LED's in RGB mode 42 x 1 W LED's in RGBW mode	36 x 1 W LED's in RGB mode, 42 x 1 W LED's in RGBW mode	36 LEDs in RGB mode, 42 LEDs in RGBW mode
Total load:	36 LED's in RGB mode 42 LED's in RGBW mode	72 LED's in RGB mode, 84 LED's in RGBW mode	144 LED's in RGB mode, 168 LED's in RGBW mode	360 LED's in RGB mode, 420 LED's in RGBW mode
Control:	USITT DMX 512, DyNet, RS232	USITT DMX 512, DyNet, RS232	USITT DMX 512, DyNet, RS232	USITT DMX 512, DyNet, RS232
DMX channels:	3, 4, 5, 7	4, 6, 8, 11	4, 12, 16, 19	4, 5, 30, 40, 43
DMX protocol modes:	5	4	4	5
Operation modes:	DMX, Mast./slave, Stand-alone	DMX, Mast./slave, Stand-alone	DMX, Mast./slave, Stand-alone	DMX, Mast./slave, Stand-alone
Built-in programs:	10	6	6	6
User editable programs:	3 (up to 50 steps each)	3 (up to 30 steps each)	3 (up to 30 steps each)	3 (up to 30 steps each)
Display:	3 digit LED	3 digit LED	3 digit LED	3 digit LED
DMX connection:	RJ45	RJ45	RJ45	RJ45
RS232 connection:	DE-9 (male)	DE-9 (male)	DE-9 (male)	DE-9 (male)
LED output connection:	RJ45	RJ45	RJ45	RJ45
Operating temperature range:	-10°C/+40°C	-10°C/+40°C	-10°C/+40°C	-10°C/+40°C
Weight:	1.1 kg	1.8 kg	2.9 kg	6.3 kg

DIMENSIONS:

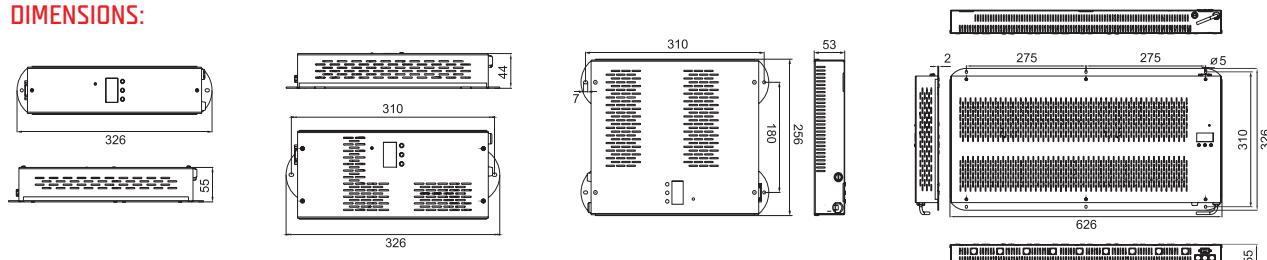



Private House, Sovereign Island, Gold Coast, Australia

ArcPower 36, 72, 144 SmartWhite

The ArcPower 36, 72, 144 SmartWhite bring to life the Anolis Smart White range of LED lighting fixtures. Electronic dimming of the individual white channels allow smooth fading through a range of colour temperatures available allowing for precise control of the colour rendering for the widest range of applications. Using industry standard protocols such as DMX 512 and RS232 along with globally recognised RJ45 connectors again the ArcPower SmartWhite range is the lighting designer's perfect solution for variable white light applications.



ArcPower

TECHNICAL SPECIFICATIONS:

	ArcPower 36 SmartWhite™	ArcPower 72 SmartWhite™	ArcPower 144 SmartWhite™
Input Voltage:	100-240 V AC, 50/60 Hz	100-240 V AC, 50/60 Hz	100-240 V AC, 50/60 Hz
Maximum Power Consumption:	60 VA	120 VA	240 VA
Number of LED output zones:	1	2	4
Max. Output current:	350 mA per internal channel	350 mA per internal channel	350 mA per internal channel
Max. load per zone:	36 x 1 W LED's	36 x 1 W LED's	36 x 1 W LED's
Total load:	36 LED's	72 LED's	144 LED's
Control:	USITT DMX 512, DyNet protocol, RS232	USITT DMX 512, DyNet protocol, RS232	USITT DMX 512, DyNet protocol, RS232
DMX channels:	1, 2, 3, 4	1, 3, 4, 6	1, 3, 5, 8, 10, 12
DMX protocol modes:	5	6	6
Operation modes:	DMX, Master/slave, Stand-alone	DMX, Master/slave, Stand-alone	DMX, Master/slave, Stand-alone
Built-in programs:	2	2	2
User editable programs:	1 (up to 50 steps)	1 (up to 30 steps)	1 (up to 30 steps)
Display:	3 digit LED	3 digit LED	3 digit LED
DMX connection:	RJ45	RJ45	RJ45
RS232 connection:	DE-9 (male)	DE-9 (male)	DE-9 (male)
LED output connection:	RJ45	RJ45	RJ45
Operating temperature range:	-10°C/+40°C	-10°C/+40°C	-10°C/+40°C
Weight:	1.1 kg	1.8 kg	2.9 kg

DIMENSIONS:

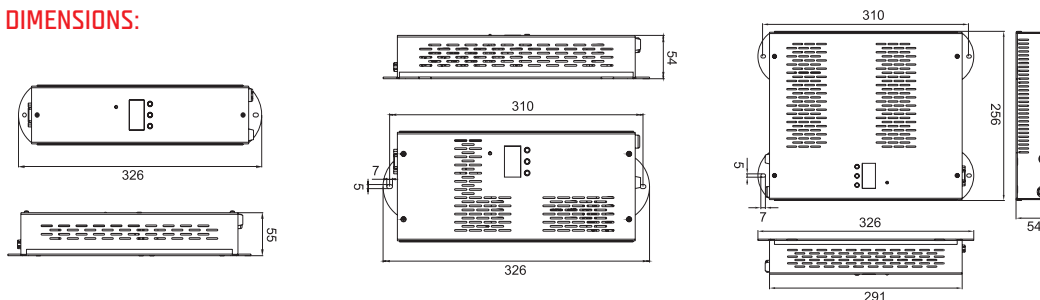



Gilgamesh Restaurant, London, The United Kingdom

ArcPower 36/K2, 72/K2

When the high output Anolis K2 range needs power and control the ArcPower 36/K2 or ArcPower 72/K2 can be used to all effects. Utilising the industry standard CAT5 connectors and including built in pre programs as well as on board programming, DMX 512 and RS232 inputs the ArcPower 36/K2 and ArcPower 72/K2 can be integrated with ease into virtually any lighting control system.



TECHNICAL SPECIFICATIONS:

ArcPower 36/K2™

Input Voltage:	100-240 V AC, 50/60 Hz
Maximum Power Consumption:	120 W
Number of LED output zones:	1
Max. Output current:	700 mA per colour
Max. load per zone:	36 x K2 or 3W LED's in RGB mode, 42 x K2 or 3W LED's in RGBW mode
Total load:	36 LED's in RGB mode, 42 LED's in RGBW mode
Control:	USITT DMX 512, DyNet, RS232
DMX channels:	3, 4, 6, 7
DMX protocol modes:	5
Operation modes:	DMX, Mast./slave, Stand-alone
Built-in programs:	10
User editable programs:	3 (up to 50 steps)
Display:	3 digit LED
DMX connection:	RJ45
RS232 connection:	DE-9 (male)
LED output connection:	RJ45
Operating temperature range:	-10°C/+40°C
Weight:	1.8 kg

ArcPower 72/K2™

Input Voltage:	100-240 V AC, 50/60 Hz
Maximum Power Consumption:	240 W
Number of LED output zones:	2
Max. Output current:	700 mA per colour
Max. load per zone:	36 x K2 or 3W LED's in RGB mode, 42 x K2 or 3W LED's in RGBW mode
Total load:	72 LED's in RGB mode, 84 LED's in RGBW mode
Control:	USITT DMX 512, DyNet, RS232
DMX channels:	4, 6, 8, 11
DMX protocol modes:	4
Operation modes:	DMX, Mast./slave, Stand-alone
Built-in programs:	6
User editable programs:	3 (up to 50 steps)
Display:	3 digit LED
DMX connection:	RJ45
RS232 connection:	DE-9 (male)
LED output connection:	RJ45
Operating temperature range:	-10°C/+40°C
Weight:	2.9 kg

DIMENSIONS:

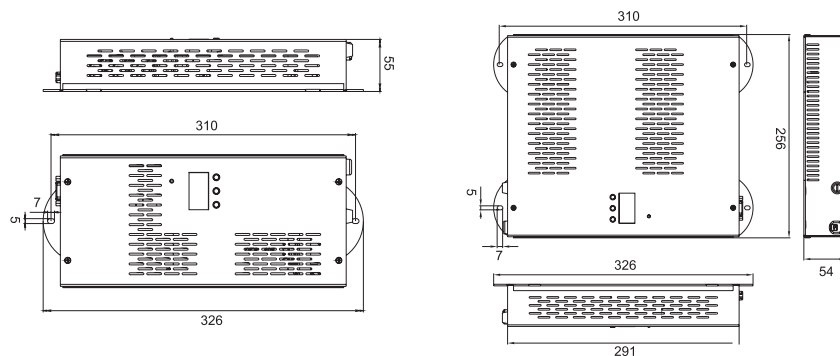



Amara Hotel, Sentosa, Singapore

ArcPower 36/K2, 72/K2 SmartWhite

The ArcPower36/K2, 72/K2 SmartWhite represent ideal drivers for Anolis K2 LED modules. Specific property of the drivers – electronic dimming of the individual white channels - allows smooth fading through range of available colour temperatures allowing for precise control of the colour rendering for applications in the decorative and architectural lighting fields.

Utilizing the industry standard CAT5 connectors, user-friendly programmability, DMX 512/RS232 inputs as well as support of DyNet protocol both drivers can be easily integrated with any lighting systems.



TECHNICAL SPECIFICATIONS:

ArcPower 36/K2 SmartWhite™

Input Voltage:	100-240 V AC, 50/60 Hz
Maximum Power Consumption:	120 W
Number of LED output zones:	1
Max. Output current:	700 mA per internal channel
Max. load per zone:	36 x Luxeon K2 LED's
Total load:	36 LED's
Control:	USITT DMX 512, DyNet protocol, RS232
DMX channels:	1, 2, 4
DMX protocol modes:	5
Operation modes:	DMX, Master/slave, Stand-alone
Built-in programs:	2
User editable programs:	1 (up to 50 steps)
Display:	3 digit LED
DMX connection:	RJ45
RS232 connection:	DE-9 (male)
LED output connection:	RJ45
Operating temperature range:	-10°C/+40°C
Weight:	1.8 kg

ArcPower 72/K2 SmartWhite™

Input Voltage:	100-240 V AC, 50/60 Hz
Maximum Power Consumption:	240 W
Number of LED output zones:	2
Max. Output current:	700 mA per internal channel
Max. load per zone:	36 x Luxeon K2 LED's
Total load:	72 LED's
Control:	USITT DMX 512, DyNet protocol, RS232
DMX channels:	1, 3, 4, 6
DMX protocol modes:	6
Operation modes:	DMX, Master/slave, Stand-alone
Built-in programs:	2
User editable programs:	1 (up to 30 steps)
Display:	3 digit LED
DMX connection:	RJ45
RS232 connection:	DE-9 (male)
LED output connection:	RJ45
Operating temperature range:	-10°C/+40°C
Weight:	2.9 kg

DIMENSIONS:

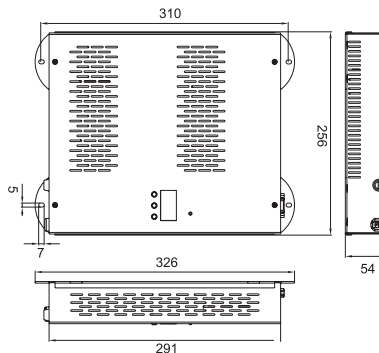
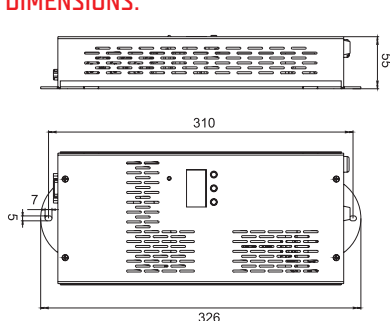



Paddington Tavern, Brisbane, Australia

ArcPower 16x6

When individual fixture control is required the ArcPower 16 x 6 comes into its own. With 16 separately DMX addressable outputs the ArcPower 16 x 6 can be used to control complex patterns and matrixes. Each output is able to power up to 6 LED's making this the perfect control option for: ArcSource 3/6/Inground/Outdoor as well as ArcLink 3 RGB. With built in programs and user editable programs the ArcPower 16 x 6 can be linked to further units and operated in a master/slave configuration. The ArcPower 16 x 6 can also be linked via DMX to the other ArcPower units in the range.



TECHNICAL SPECIFICATIONS:

ArcPower 16x6™

Input Voltage:	100-240 V AC, 50/60 Hz
Maximum Power Consumption:	170 W
Number of LED output zones:	16
Max. Output current:	350 mA per colour
Max. load per zone:	16x6 LEDs (RGB mode), 12x8 LEDs (RGBW mode)
Total load:	96 LED's
Control:	USITT DMX 512
DMX channels:	48, 50
DMX protocol modes:	2
Operation modes:	DMX, Stand-alone
Built-in programs:	5
User editable programs:	4 (up to 60 steps each)
Display:	4 digit LED
DMX connection:	RJ45
LED output connection:	RJ45
Operating temperature range:	-10°C/+40°C
Weight:	2 kg

DIMENSIONS:

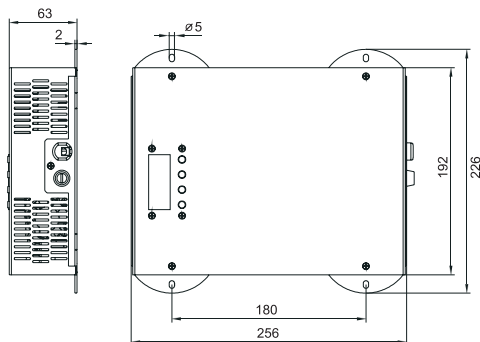



Leeds Academy, Leeds, The United Kingdom

ArcPower 48

The ArcPower has been designed and manufactured to the same high standards as the ArcPower 36 to bring to life the phenomenal ArcPad 48 range. Delivering the perfect balanced power to the ArcPad 48's rebel LED's the ArcPower 48 means that ArcPad's are able to be seamlessly integrated into installations combining other Anolis products.

Multi connectivity including DMX, RS232, and Dynet via industry standard CAT5 connections means ArcPower 48 is easily interfaced with the widest variety of standard lighting control systems.



TECHNICAL SPECIFICATIONS:

ArcPower 48™

Input Voltage:	100-240 V AC, 50/60 Hz
Maximum Power Consumption:	60 W
Max.Output current:	700 mA/white, green, blue; 420 mA/red
Max.load:	48 Luxeon Rebel LEDs
Control:	USITT DMX 512, RS232
DMX channels:	3, 4, 6, 7
DMX protocol modes:	5
Operation modes:	DMX, Mast./slave, Stand-alone
Built-in programs:	10
User editable programs:	3 (up to 50 steps each)
Display:	3 digit LED
DMX connection:	RJ45
RS232 connection:	9-pin D connector
Operating temperature range:	-10°C/+40°C
Weight:	1.1 kg

DIMENSIONS:

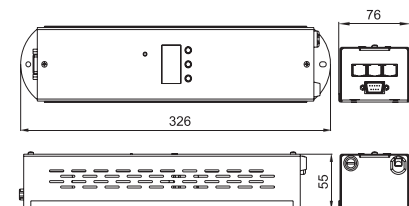



Krys Optical, Wattrelos, France

ArcPower 384 Rack-Mount

With many of today's LED's installations becoming more and more technically demanding the ArcPower 384 Rack Mount sets new standards in LED driver technology. Offering 8 individually controllable outputs, ArcPower 384 Rack Mount is compatible with DMX, RDM (remote device management), Art Net and DyNet allowing the widest range of flexibility with advanced LED installations. High quality components and Anolis custom software ensures the highest level of reliability that has become a standard with the rest of the Anolis Arcpower range. A graphic display panel combined with the ANS (Anolis Navigation System) makes accessing the functions of the ArcPower 384 rack Mount a simple and intuitive experience. Demanding installation such as, Shopping Malls, Entertainment Complexes, Stadiums, Museums, Theme Parks and Virtually all high specifications LED installations can benefit from the huge flexibility of the Anolis Arcpower 384.



ArcPower

TECHNICAL SPECIFICATIONS:

ArcPower 384 Rack-Mount™

Power supply:	Electronic auto-ranging
Input Voltage:	100-250 V AC, 50/60 Hz
Maximum Power Consumption:	650 W
Number of LED output zones:	8
Max. Output current:	350 or 700 mA per colour
Max. load per zone:	36 LED's in RGB mode, 48 LED's in RGBW mode
Total load:	288 LED's in RGB mode, 384 LED's in RGBW mode
Control:	USITT DMX 512 (RDM support), Art-Net (ready for ACN), DyNet, RS232
DMX channels:	3, 5, 24, 32, 36
DMX protocol modes:	5
Operation modes:	DMX, Stand-alone
User editable programs:	3 (up to 30 steps each)
Display:	Blue/white LCD graphic
Setting & Addressing:	Anolis Navigation System (ANS)
Connections:	DMX IN/OUT: Locking 3-pin and 5-pin XLR
Dynet:	RJ45
ArtNet:	RJ45
RS232:	DE-9 (male)
AC power input:	Neutrik PowerCon, A-type, NAC3MPA
Maximum ambient operating temperature:	+40°C
Mounting:	19" Rack-Mount (2U)
Weight:	7.5 kg

DIMENSIONS:

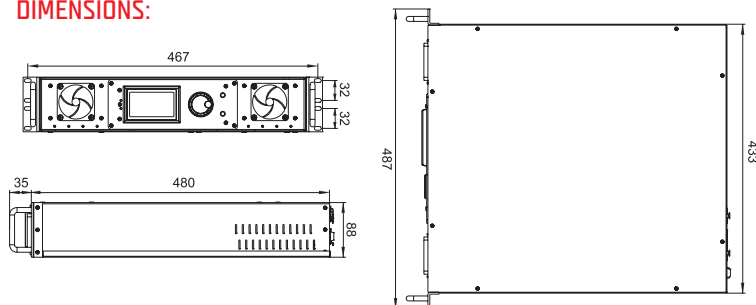



Gilgamesh Restaurant, London, The United Kingdom

ArcControl 1024

Anolis ArcControl 1024 is a feature-rich, fully programmable DMX controller, designed to offer comprehensive and intuitive control of all Anolis fittings as well as third party DMX controlled luminaires. It is ideal for the widest possible range of applications including commercial and residential installations - restaurants, bars, hotels, modern interiors, lightscapes, retail outlets, point-of-sales, illuminated signs and exhibition stands. Anolis ArcControl 1024 is a totally stand-alone system and is wall-mounted it requires no additional equipment to control DMX fittings, and fits neatly into a 47 mm deep back box, surface mount and frame mount options are also available. Anolis ArcControl 1024 includes a comprehensive library of all Anolis luminaires and other effects for easy installation and programming. The LCD display and scroll-wheel combined with the real time astronomical clock allows for more complex sequences, timed events and colours to be added without requiring the use of a computer.



TECHNICAL SPECIFICATIONS:

ArcControl 1024™

DMX Channels:	2 complete universes of 512 channels each
DMX Standard:	DMX 1990 A
DMX refresh rate:	Configurable, 36 Hz Max
Power Supply:	15 V DC, 300 mA, (included)
Networking:	Ethernet 10/100 MHz - Auto uplink detection Built-in web server Telnet command server
Analogue channels:	3 independent 0-10 V outputs, 50 mA
Contact inputs:	3 volt-free contact inputs
Audio Input:	Line-level mono audio input for beat triggering
Real-time clock:	Built-in real-time clock, with 6-month battery back-up
LCD Screen:	128x64 pixel, monochrome with configurable RGB backlight
Physical Size:	35 mm deep, Fits standard 47 mm-deep UK double-gang backbox
Weight:	255 grammes, without fascia
Standard Fascia:	Stainless Steel



Gilgamesh Restaurant, London, The United Kingdom

ArcSplitter 4, 2x12

The ArcSplitter unit splits LED outputs of the ArcPower drivers into several branches. The ArcSplitter allows cabling of multiple LED modules more easily and faster. Small and compact in design, mounting holes in the unit's housing allow easy installation without extra PSU needed. All splitters are equipped with RJ45 sockets for data input/output. The ArcSplitter 4 splits one LED output of the ArcPower driver into 4 branches. The ArcSplitter 2x12 splits two LED outputs of the ArcPower driver into 12 branches each.



TECHNICAL SPECIFICATIONS:

	ArcSplitter 4™	ArcSplitter 2x12™
Number of LED outputs:	4	2x12
LED in/out:	RJ 45 sockets	RJ 45 sockets
Construction:	No extra PSU needed Sheet metal housing	No extra PSU needed Sheet metal housing
Fixation:	2 mounting holes with diameter of 5 mm	4 mounting holes with diameter of 5 mm
Weight:	0.5 kg	1.9 kg

Standard and Rack mounting version available.

DIMENSIONS:

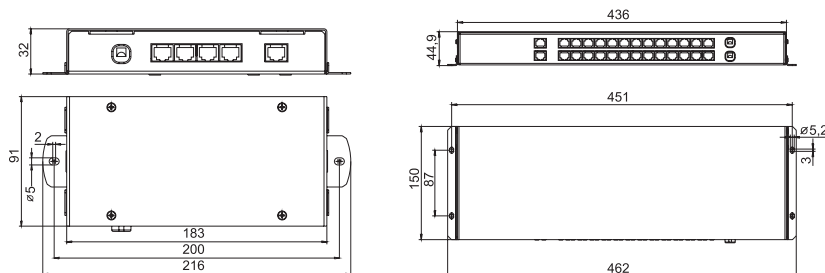

CONTENT:

■ ArcSource 1.....	7
■ ArcSource 3, 6, 7.....	9
■ ArcSource 12, ArcSource 12 SmartWhite	11
■ ArcSource 3/K2, 12/K2.....	13
■ ArcSource Inground 3, 6, 7	15
■ ArcSource Inground 12, 36.....	17
■ ArcSource Outdoor 3, 6, 7.....	19
■ ArcSource Outdoor 12, 36.....	21
■ ArcSource Wall 3, Twin Wall 3.....	23
■ ArcLink 3, 4, ArcLink Optic 3, 4.....	25
■ ArcLine 12, 18, 24, 36.....	27
■ ArcLine Optic 12, 18, 24, 36.....	29
■ ArcLine Optic 12, 18, 24, 36 Smart White	31
■ ArcLine Outdoor Optic 18, 24, 36, ArcLine Double Outdoor Optic 36, 48, 72	33
■ ArcLine Outdoor Optic 18, 24, 36/K2, ArcLine Double Outdoor Optic 36, 48, 72/K2	35
■ ArcPAR 3, 12.....	37
■ ArcPad 48, ArcPad 48 Integral	39
■ ArcPad Xtreme.....	41
■ ArcSource 96 Integral.....	43
■ ArcWash 236, ArcWash Recessed 236	45
■ ArcPower 9, 12	47
■ ArcPower 36, 72, 144, 360.....	49
■ ArcPower 36, 72, 144 SmartWhite	51
■ ArcPower 36/K2, 72/K2	53
■ ArcPower 36/K2, 72/K2 SmartWhite	55
■ ArcPower 16x6	57
■ ArcPower 48.....	59
■ ArcPower 384 Rack-Mount	61
■ ArcControl 1024.....	63
■ ArcSplitter 4, 2x12	65

NOTES:



ANOLIS is an architectural division of ROBE

HQ & Factory: ROBE lighting s. r. o., Hážovice 2090, 756 61 Rožnov p. Radhoštěm, Czech Republic, Tel.: +420 571 751 500, Fax: +420 571 626 337, E-mail: robe@robe.cz

UK: ROBE UK Ltd., Northampton, UK, Tel.: 01604 741000, E-mail: info@robeuk.com, **South-East Asia:** ROBE S.E.A., Singapore, Tel.: +65-8118 6665, E-mail: info@robe-sea.com

America: ROBE Lighting Inc., Sunrise, FL, USA, Tel.: +1 954 615 9100, E-mail: info@robelighting.com

September 2009

w w w . a n o l i s . e u